



METEOR

WIDE TOLERANCE FLANGE ADAPTORS

INSTALLATION INSTRUCTIONS



EN: METEOR WIDE TOLERANCE FLANGE ADAPTORS
INSTALLATION INSTRUCTIONS



FR: BGT ADAPTATEUR À BRIDE GRANDE TOLÉRANCE "METEOR"
INSTRUCTIONS D'INSTALLATION



ES: ADAPTADORES DE BRIDA DE AMPLIA TOLERANCIA "METEOR"
INSTRUCCIONES DE INSTALACIÓN



NL: METEOR GROOTBEREIK FLENSADAPTERS
INSTALLATIE INSTRUCTIES



PL: ŁĄCZNIK KOŁNIERZOWY MULTIDIAMETRALNY METEOR
INSTRUKCJA MONTAŻU



BAYARD RANGE



METEOR WIDE TOLERANCE FLANGE ADAPTORS

INSTALLATION

METEOR flange adaptors are supplied ready assembled and require no disassembly.

Size Range DN 50 to DN 300

Prior to installation:

- ⇒ Check if the quality of the EPDM gasket and coating of the flange adaptor are suitable for the conveyed medium.
- ⇒ During storage (1 year maximum), the METEOR flange adaptor must be protected from any adverse weather and pollution in its original packaging so as to protect it against aggressive conditions (the sun's rays and the heat), to avoid any deterioration of the elastomers and the coating. Ensure that the box is stored in a stable position. Take care not to damage the coating and joints during installation.
- ⇒ Before starting work, ensure that all safety rules are followed in accordance with local legislation in force.
- ⇒ When connecting to thin-walled PVC pipes, the use of an insert is recommended!
- ⇒ Warning! If our products are installed on a pipe that may contain asbestos, you must comply with the regulations on the protection of workers against the risks related to exposure to asbestos.
- ⇒ **METEOR wide tolerance flange adaptors do not prevent pull out of pipes** which must be anchored in other ways.

PVC-U	PVC-BO	DUCTILE IRON	CAST IRON	STEEL	FIBRE CEMENT
✓	✓	✓	✓	✓	✓

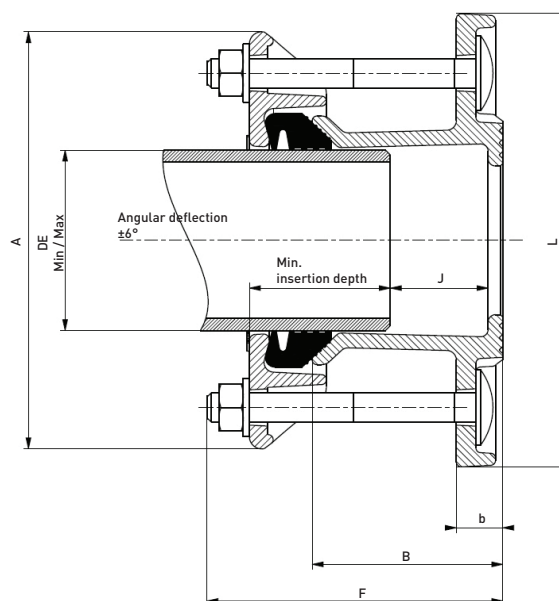

DN	Flange Drilling		Size Range [DE]		L	A	F	B	b	J max	Min. Insertion Depth	Bolts	Weight [KG]
	PN 10/16	ANSI 150	Min	Max									
40/50	40 & 50	2"	44	59	170	155	121	78	19	40	60	2x M12x110	2.7
50/65	50 & 65	2" & 2 1/2"	56	74	186	175	121	78	19	40	60	2x M12x110	3.4
60/65	60 & 65	2 1/2"	63	85	202	185	131	78	19	40	60	2x M12x120	3.9
80	80 & 100	3" & 4"	85	107	226	210	131	78	19	40	60	3x M12x120	4.9
100	100 & 125	4" & 5"	107	132	262	245	131	80	19	40	70	3x M12x120	6.4
125	125 & 150	5" & 6"	125	148	285	260	131	80	19	40	70	3x M12x120	6.5
125	125 & 150	5" & 6"	132	158	285	260	131	80	19	40	70	3x M12x120	6.8
150	150	6"	157	184	312	300	131	82	19	40	70	4x M12x120	8.3
200	200	8"	180	207	345	320	144	89.5	20	40	80	4x M12x130	11.0
200	200	8"	200	227	365	350	144	89.5	20	40	80	4x M12x130	12.7
200	200	8"	218	245	380	370	235.5	160	20	90	85	4x M12x220	15.8
250	250	10"	248	275	418	400	155	100	22	50	85	6x M12x140	15.4
250	250	10"	271	297	433	420	215	160	22	90	90	6x M12x200	19.2
250	250	10"	292	318	455	440	215	160	24.5	90	90	6x M12x200	22.7
300	300	12"	311	336	488	455	215	160	24.5	55	90	6x M12x200	23.5
300	300	12"	334	361	500	485	215	160	24.5	90	90	6x M12x200	25.7



INSTALLATION / OPERATION

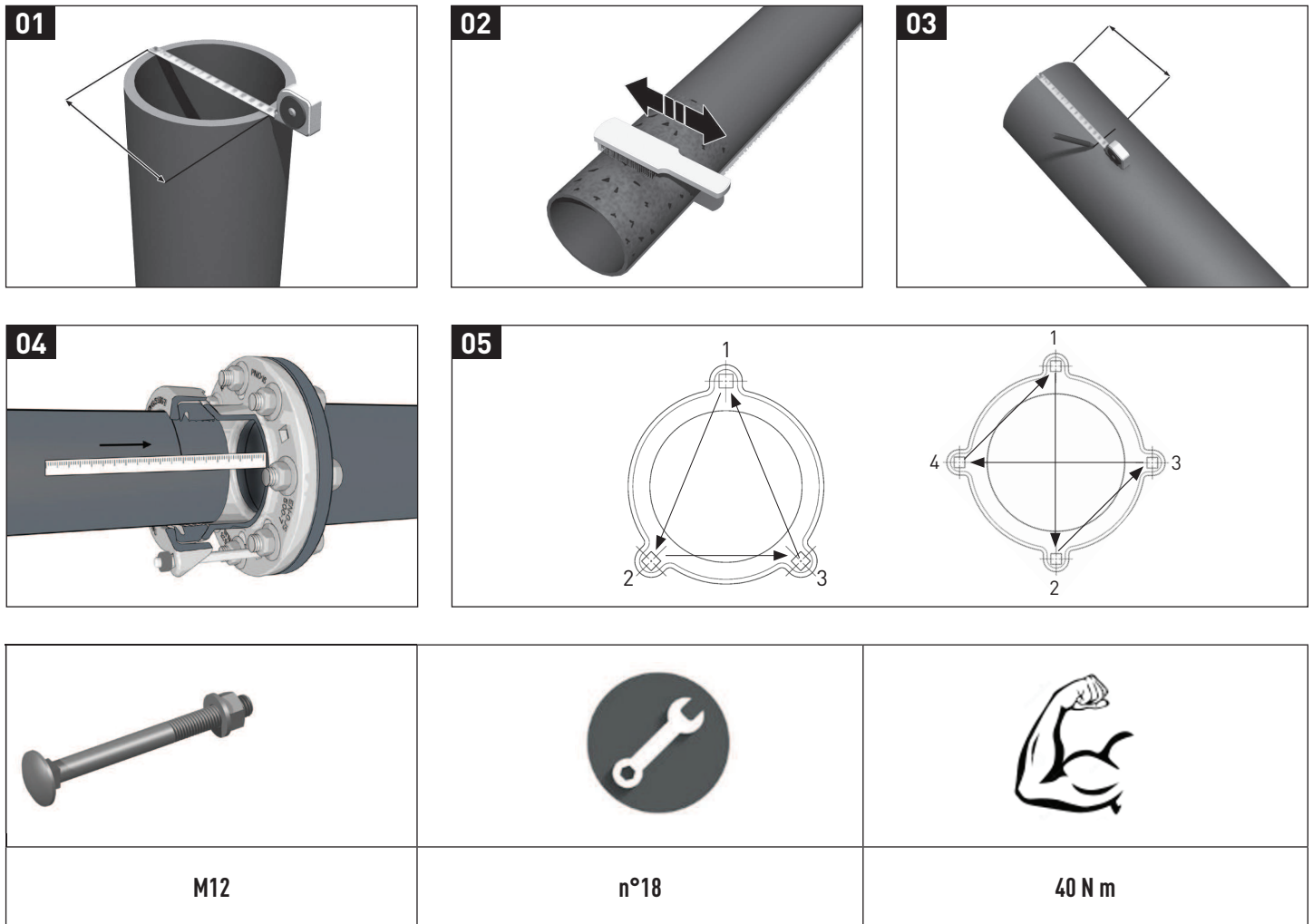

1. Examine pipe ends to which the fitting is to be connected for defects prior to installation. Ensure pipes are round and square. Check that the selected flange adaptor matches the pipe outside diameter and the flange drilling.
2. Clean pipe end with a brush, removing oil, dirt, loose scale, rust and foreign material over a distance of 250mm. The pipe surfaces must be clean and smooth and have no defect that may affect the performance of the adaptor.
3. To aid the installation mark the pipe end at the minimum insertion depth shown in the table on page 2.
4. Align the pipe respecting the minimum setting gap J (see page 2) and the angular deflection. If in any doubt please contact TALIS technical support. Slide the sleeve over the end of the pipe ensuring that the marked minimum insertion depth is respected. Rotate the flange adaptor so that the nuts can be tightened easily, ensuring that the flange adaptor is aligned with the flange connecting bolts. Fit a flat flange gasket, ensuring that it is concentric to the flange bolts, and bolt the flange adaptor to the mating flange using the standard flange bolting procedure.
5. Use a torque wrench to tighten the nuts. In the case of an adaptor with three bolts tighten the nuts in one or two turns at a time by applying a triangular pattern. In the case of the adaptor having 2, 4 or 6 bolts, tighten the nuts one or two turns at a time by following a diametrically opposed pattern. All the nuts must be thoroughly tightened to the recommended torque in this manual. Once this is completed, the radial gap between the flange adaptor and the pipe should be even all around. Rubber may be visible between the body and the end ring.



TALIS is the undisputed Number One for water transport and water flow control. TALIS has the best solutions available in the fields of water and energy management as well as for industrial and communal applications. We have numerous products for comprehensive solutions for the whole water cycle – from hydrants, butterfly valves and knife gate valves through to needle valves. Our experience, innovative technology, global expertise and individual consultation processes form the basis for developing long-term solutions for the efficient treatment of the vitally important resource “water”.

