

ΚΡΟΥΝΟΙ ΑΠΟΣΤΡΑΓΓΙΣΗΣ

**KLINGER
SHUT - OFF FITTINGS**

Model ABL 12 (PN 160)



1- GENERAL

- PN 160
- ANSI 900
- Material : Steel (material code FS/H), acid resistant steel (material code M).

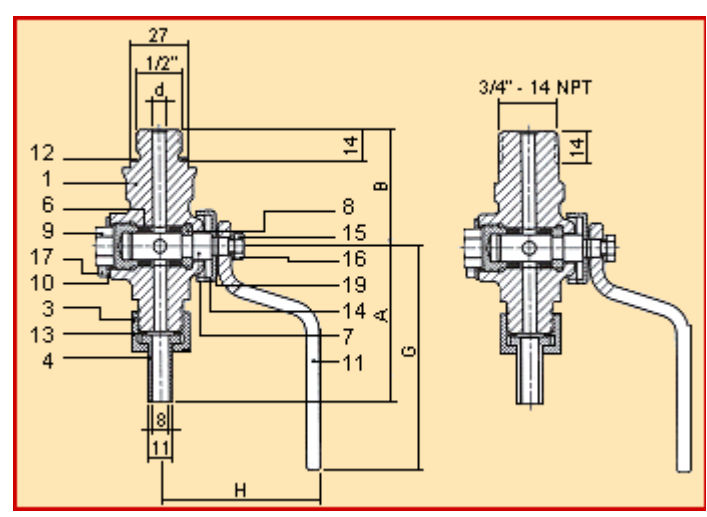

Part	Material code	
	FS/H	M
1 Body	1.0460	1.4408
3 Union nut	9SMn28K	1.4305
4 End tube	St	1.4401
6 Packing sleeve	Graphite	Graphite
7 Cock plug	1.4401	1.4401
8 Split ring	1.4401	1.4401
9 Tightening nut	1.4401	1.4401
10 Locking plate	1.4401	1.4401
11 Cock handle	GTS-35/Polyamid	GTS-35/Polyamid
12 Joint ring	Soft nickel	Soft nickel
13 Joint ring	K-Sil	K-Sil
14 Stop	1.4401	1.4401
15 Hexagonal head screw	A4	A4
16 Washer	A4	A4
17 Cheese-head. Screw	A4	A4
19 Locking ring	1.4034	1.4034

Overall dimensions in mm

Cock type	d	A	B	G	H
ABL 12	6	68.5	35	118	67



AB-cocks Materials

Materials for AB-cocks

Material code	Body	Cock plug	Tightening nut	Split ring
IV	Hot pressed brass Ms 58p (2.0401)	Hot pressed brass Ms 58p, (2.0401)	2.0401 1.4401 1.4016	Stainless steel 1.4401
VII, VIII	Forged steel C 22,8 (1.0460)	Stainless steel 1.4401		
X, Xc	Stainless steel 1.4571	Stainless steel 1.4401	Stainless steel 1.4401	

Equivalent material codes

Material code acc. to KLINGER	Material class	DIN-code	ANSI-code	BS-code	ASTM-code
C22,8 VIII	Forged steel	C22,8	M1020	1503–161 Gr.B	A181 Gr. II
Ms58p IV	Hot pressed brass	Ms58p	–	B36-Nr. 8	–
9SMn28K	Machining steel	9SMn28K	1213	2030Mo7	–
St 37.2	Steel	1.0037	–	–	–
1.4571 Xc	Stainless steel	X8CrMoTi 17	316 Ti	320 S 31	–
1.4401	stainless cr.-steel	X5CrNiMo 1810	316	316-S 16	A182-F316

* AISI- BS- and ASTM-codes are the nearest to DIN

Materials and measurements of packing sleeves

Four-hole packing sleeve

Two-hole packing sleeve

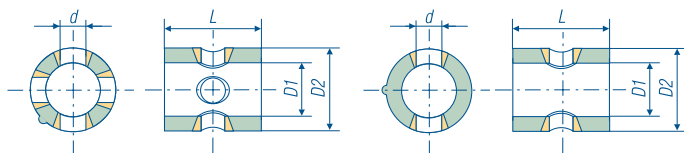

Cock size	Nominal width mm Zoll d	Internal ∅ D 1	External ∅ D 2	Length L	Number of holes	Weight ca. kg	Suitable for cock type	Material	
AB 10							ABB 10 on request	PTFE, KFG	
AB 12	6	1/4	12	18	23	2	0,006	ABL 12, ABM 12, ABZ 12, MABI 12, ABI 12, ABIE 12, ABS 12	KAF, KOR-AF, PTFE, KFG
AB 12	3,25	1/8	12	18	23	4	0,007	MABA 12, MABC 12, MABU 12	PTFE, KFG, KOR-AF
AB 18	8	5/16	18	26	32	2	0,019		KAF, KOR-AF PTFE, KFG



Pressure- temperature limits to ISO 7005/3 and EN 1092-3

Type: Klinger AB-cock MAB 12
 Material: 2.0401
 CuZn39Pb3
 Klinger Wkz. IV
 Pressure rate: PN 40

Point	Temperature °C	Pressure (bar)
A	120	40
B	150	38.5
C	180	34
D	200	30
E	220	25.5
F	240	21.5
G	250	19.5

Pressure- temperature limits to ISO 7005/1

Type: Klinger AB-cock AB12, MAB12, AB18
 Material: 1.0460
 C22.8
 Klinger m. c. VIII
 Pressure rate: PN 160

Point	Temperature °C	Pressure (bar)
A	50	160
B	100	148.3
C	150	144.7
D	200	140.2
E	250	133.5
F	300	123.9
G	350	118.2
H	375	116.6
I	400	110.4

Low temperature limits

(acc. to AD-code of practice W10 or KLN 845/2)

Stress condition	Temp.	PN160
I	-20°C	160 bar
II	-60°C	120 bar
III	-80°C	40 bar

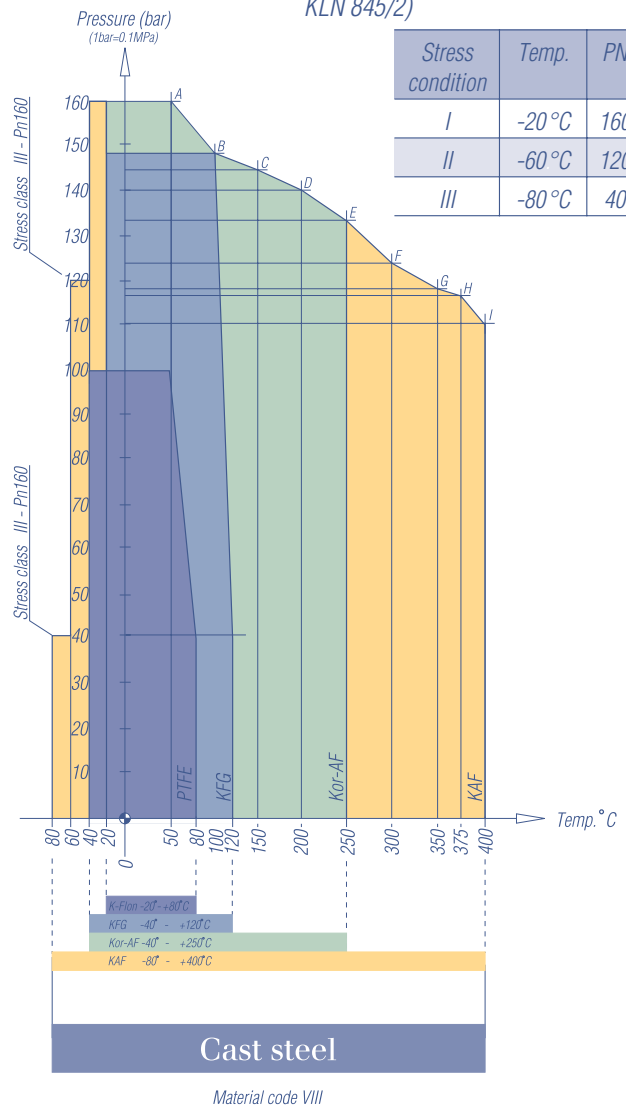
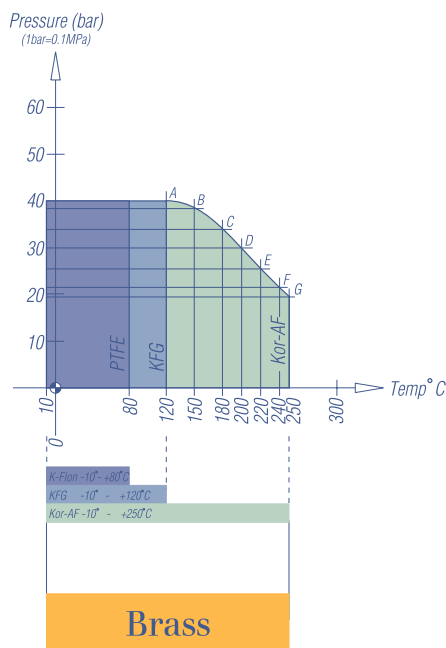

Maintenance and installation

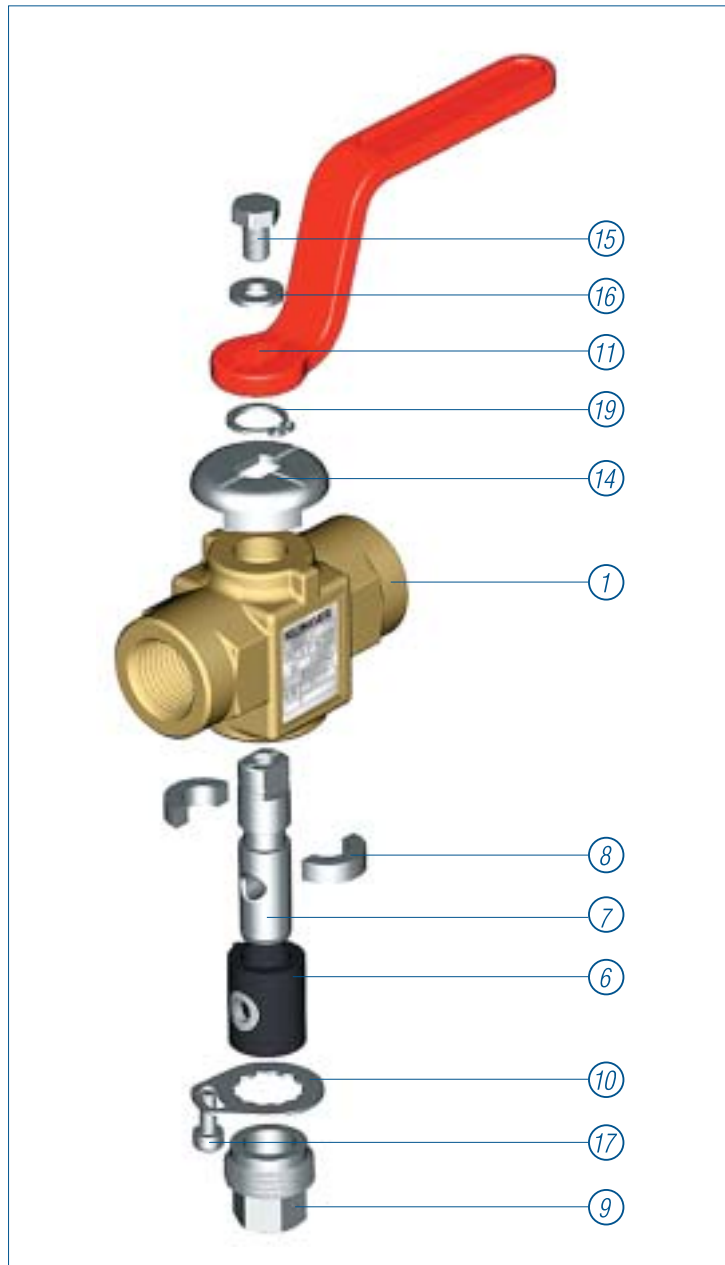

- Packing sleeves of KAF and KOR-AF – fabricated from graphite or SIL-laminate – are treated with PTFE which ensures smooth operation of the cock throughout the life time of the packing sleeve.
- Resistant to nearly every medium met in the different branches of industry such as steam, hot water, oils, solutions, many alkalis, acids and numerous chemicals.
- Suitable for especially aggressive media are packing sleeves of the quality KFG (= PTFE reinforced with glass fibre) and PTFE.

Simple maintenance

If after years an AB- or MAB-cock starts to leak all that needs to be done is for the nut to be fastened so that the packing sleeve is tightly enclosing the plug. Therefore the cock must be in OPEN position. Economical because replaceable without problems.

Disassembly / installation

Note: Each KLINGER-cock comes with a detailed mounting instruction.

Loosen the cap screw (17), remove locking disc (10), unscrew tightening nut (9), loosen the lever screw (15), remove washer (16) and lever (11) from the cock plug (7). Remove safety ring (19) and the stop (14) from the cock plug (7). Knock the cock plug (7) to-

gether with the split ring (8) and the packing sleeve (6) out of the body (1). Remove the split ring (8) and push the plug (7) through the packing sleeve (6). Now replace the packing sleeve and together with plug and split ring push it back into the body whereby you have to align the tongue of the packing sleeve with the groove inside the body. Put stop, safety ring and lever back into

place and fix with the lever screw. Bring cock to open position, tighten screw with indicated torque (15 Nm ^{+15Nm}) and secure with locking disc.