

ΣΦΑΙΡΙΚΟΙ ΚΡΟΥΝΟΙ ΟΡΕΙΧ. ΜΕΒ ΜΕ ΠΕΤΑΛΟΥΔΑ

DESCRIPTION

Ball valve with tail and T handle



FEATURES

- brass CW617N body, ball, stem and nut and tail.
- ball ground by diamond-tipped tool, chromium plated.
- virgin P.T.F.E. seats with 7° min. tightness angle.
- o-ring stem packing in NBR rubber.
- aluminium T lever.
- Nickel plated finishing.
- threading to ISO 228/1.
- PN 16: TEMP. : -20°C ÷ 120°C

LEADING DIMENSIONS

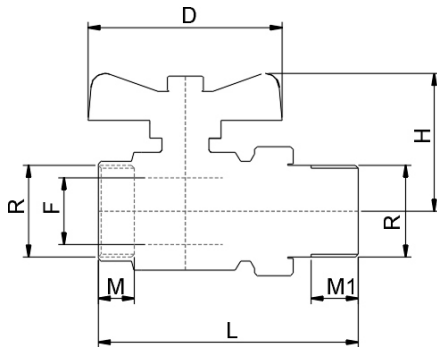

R	½"	¾"	1"	1 ¼"
D (mm)	54	54	70	70
H (mm)	36	41	49.5	62
L (mm)	73	82.5	94	112
M (mm)	12.5	12	13.5	14
F (mm)	14.5	19	24	30

WORKING PREASSURES AT 80°C

PN 16	*	*	*	*	p.s.i. 250
	1/2"	3/4"	1"	1 ¼"	

PRESSURE DROPS

R"	½"	¾"	1"	1 ¼"
Kv	15	30	57	94

$$\Delta P [\text{mm H}_2\text{O}] = 10.000 \times \left[\frac{G [\text{m}^3/\text{h}]}{Kv} \right]^2$$